

# EXHIBIT B UTILITY DESIGN SHEET

PROJECT

Utility Co. #	Conflict #
---------------	------------

Utility Owner: Falcon Broadband  Public  Private

### SECTION TO BE COMPLETED PRIOR TO NEGOTIATION MEETING

**Existing Condition** 1260+ to 1524+ on East Side ROW. / North Gate on North Side Feeds AFFA

1. General Location

2. Utility type:  Electric  Gas  Communications  Water  Sanitary  Cable TV  Irr. Canal  
 Other Fiber - Internet - phone.

3. Location by:  Utility plat maps;  Field located and surveyed:  Yes  No; Pothole:  Yes  No  
 If pothole, # \_\_\_\_\_ from:  CDOT pothole or  DBC pothole HCL used: \_\_\_\_\_  
 Station: \_\_\_\_\_ to Station: \_\_\_\_\_ Dist. from HCL: \_\_\_\_\_ Rt. / Lt. \_\_\_\_\_

4. Utility size & type of materials: 1/2" conduit and fiber

5. Environmental Concerns: mouse Area.

6. Encased:  No  Yes, if so size & material: \_\_\_\_\_  
 This section completed by DBC Rep.: \_\_\_\_\_ Date: \_\_\_\_\_

### SECTION TO BE COMPLETED AT NEGOTIATION MEETING

**Proposed Resolution**

1. Recommendation:  left alone  modified  removed  relocated  upgraded  abandoned in place  
 Conflict with: \_\_\_\_\_

2. This utility may be modified/relocated to: \_\_\_\_\_  
 Station: \_\_\_\_\_ to Station: \_\_\_\_\_ Dist. from HCL: \_\_\_\_\_ Rt./Lt. \_\_\_\_\_

3. Utility in:  CDOT ROW  other public ROW  Easement (attach copy)  other \_\_\_\_\_

4. Who will do the Utility Relocation Plan:  Utility Company (UC)  Design/Build Contractor (DBC)

5. Who will do the construction:  Utility Company (UC)  Design/Build Contractor (DBC)

6. UC to perform inspection?  No  Yes, if so conditions: \_\_\_\_\_

7. Number of days required for prior notification by DBC for construction by UC: \_\_\_\_\_ days

8. Number of days required by UC or DBC to complete Utility Relocation Plan: \_\_\_\_\_ days; Construction: \_\_\_\_\_ days.

9. Any construction details unique to this location?  No  Yes, if yes describe: \_\_\_\_\_

10. Utility can be disconnected for: \_\_\_\_\_ days/hours.

11. Other proposed action: \_\_\_\_\_

12. Contractor Drawings confirming conflict must be attached  
 This section completed by: Utility Co. \_\_\_\_\_ Date: \_\_\_\_\_ DBC \_\_\_\_\_ Date: \_\_\_\_\_

I-25 EA CONCEPTUAL DESIGN

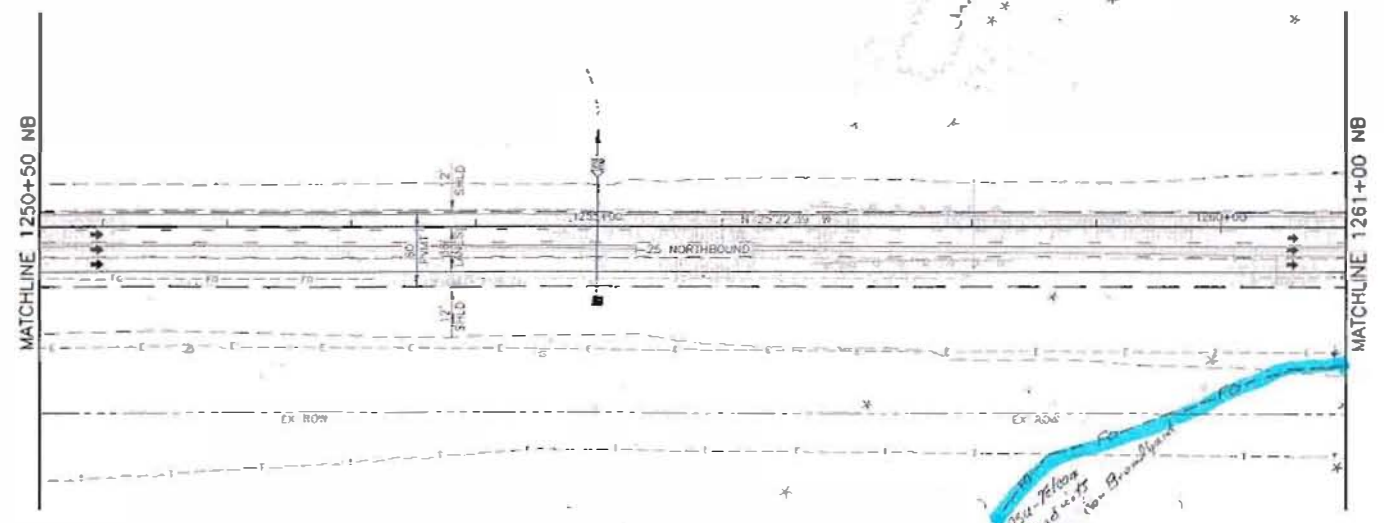
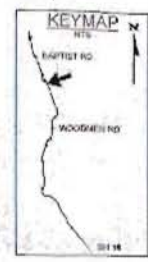
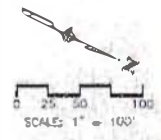

1250+00 NB  
 REMOVE 75' x 75' ROW  
 RECID .56' x 24' x 100' MERCP  
 @ 1.0% END SECTION AND  
 REPAIR 1' RECORD BUGH  
 1' FILE TYPE D TO  
 1' FILE TYPE I TO  
 Curve = 25' CS  
 AWW = 4' Drive = 24'



Computer File Information			Sheet Revisions			Colorado Department of Transportation			As Constructed		I-25 Roadway Plan		Project No./Code	
Creation Date:	11/12/01	Plots: MAB	(R-)			 1450 Beal Lake Loop - Suite A Colorado Springs, Colorado 80906 Phone: (719) 534-7323 Fax: (719) 272-3248	No Revisions:		1250+50 NB to 1261+00 NB		C 0252-316			
Last Modification Date:	02/28/03	Inputs: MAB	(R-)				Revised:		Designer: MAB		12210			
File Path:	P:\983100913\ACAD\YSHEETS		(R-)				Void:		Detailer: MAB		Sheet Number			
Drawing File Name:	RDPL76-855.DWG		(R-)				Sheet Subset: ROADWAY		Subset Sheet: 84 NB of 113					
Acad Ver:	2000	Scale: As Shown	(R-)				Region 2		JFF					

**Computer File Information**

Station Date	11/17/00	Author	WJG
Last Modification Date	02/23/02	Issue	WJG
Full Path	I:\98310691\1261+00\1261+00.DWG		
Drawing File Name	1261+00.DWG	Sheet Design	WJG
Acad Ver.	2000	Scale As Drawn	AS PER PLAN

**Sheet Revisions**

**Colorado Department of Transportation**

Region 2

1660 Good Road, Long - 80404  
 Denver, CO 80202  
 Phone: (303) 769-2000 Fax: (303) 769-2000

JTF

**As Constructed**

By	WJG
Checked	WJG
Date	

**1-25 Roadway Plan NB**

Design	WJG
Checked	WJG
Sheet Name	1261+00 NB
Sheet No.	05 NB of 113

**Project No./Code**

Project No.	C 0252-316
Code	12210



201  
 202  
 203  
 204  
 205  
 206  
 207  
 208  
 209  
 210  
 211  
 212  
 213  
 214  
 215  
 216  
 217  
 218  
 219  
 220  
 221  
 222  
 223  
 224  
 225  
 226  
 227  
 228  
 229  
 230  
 231  
 232  
 233  
 234  
 235  
 236  
 237  
 238  
 239  
 240  
 241  
 242  
 243  
 244  
 245  
 246  
 247  
 248  
 249  
 250  
 251  
 252  
 253  
 254  
 255  
 256  
 257  
 258  
 259  
 260  
 261  
 262  
 263  
 264  
 265  
 266  
 267  
 268  
 269  
 270  
 271  
 272  
 273  
 274  
 275  
 276  
 277  
 278  
 279  
 280  
 281  
 282  
 283  
 284  
 285  
 286  
 287  
 288  
 289  
 290  
 291  
 292  
 293  
 294  
 295  
 296  
 297  
 298  
 299  
 300

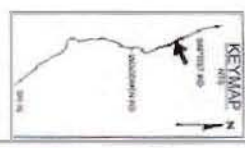
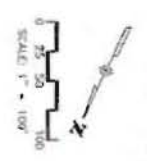
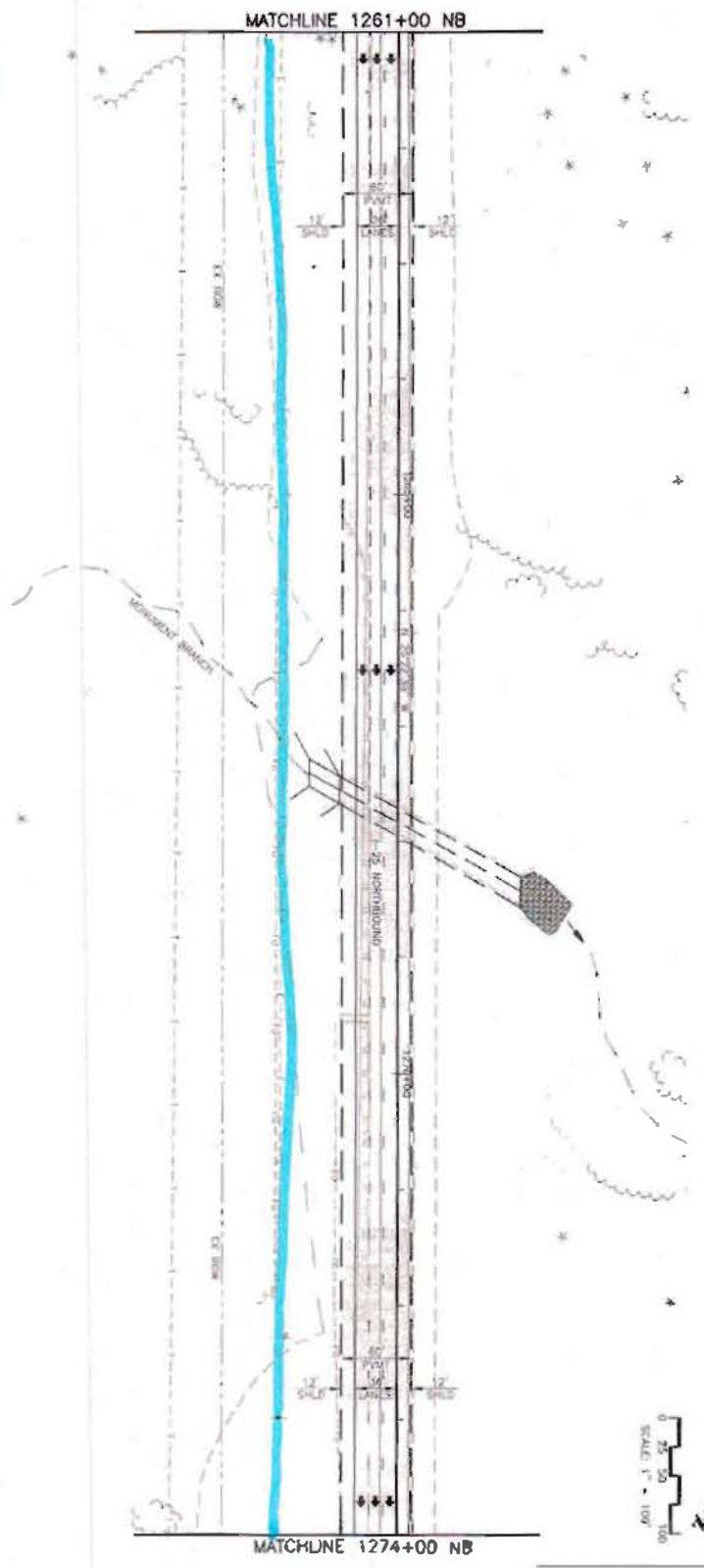

1-25 EA CONCEPTUAL DESIGN

<b>Computer File Information</b>		<b>Sheet Revisions</b>		<b>Colorado Department of Transportation</b>		<b>As Constructed</b>		<b>1-25 Roadway Plan NB</b>		<b>Project No./Code</b>	
Created Date:	11/7/01	1		 1600 Quad Lake Loop - Suite A Colorado Springs, Colorado 80905 Phone: (719) 685-5251 Fax: (719) 237-2398 JFT	No. Revisions: 0 Revised: Submittal: Submittal Sheet: 00 NB of 113	1274+00 NB to 1287+00 NB 443 122710	C 0252-316 122710				
Unit Modification Date:	02/29/03	2									
Unit Name:	P:\AN\1001\10\CDOT\01010	3									
Drawing File Name:	101010A-021.DWG	4									
Sheet No.:	2002	5									
Scale:	Scale as Shown	6									
Language:	01010 English	7									

1276+50 NB  
 REMOVE 5' x 7' x 75' CONC.  
 CURB AND SIDEWALKS AT  
 R.O.T.D. SIGNAL 10' x 8' x 130'  
 CONC. & CURB, SIDEWALK AND  
 SIDEWALKS 1' AND RT. REPAIR  
 1" REGRADE DITCH 1' AND RT.  
 TO 350 SQ. YD. @ 220 CFS  
 400' x 800 CFS  
 400' x 7' Ditch = 2.0'

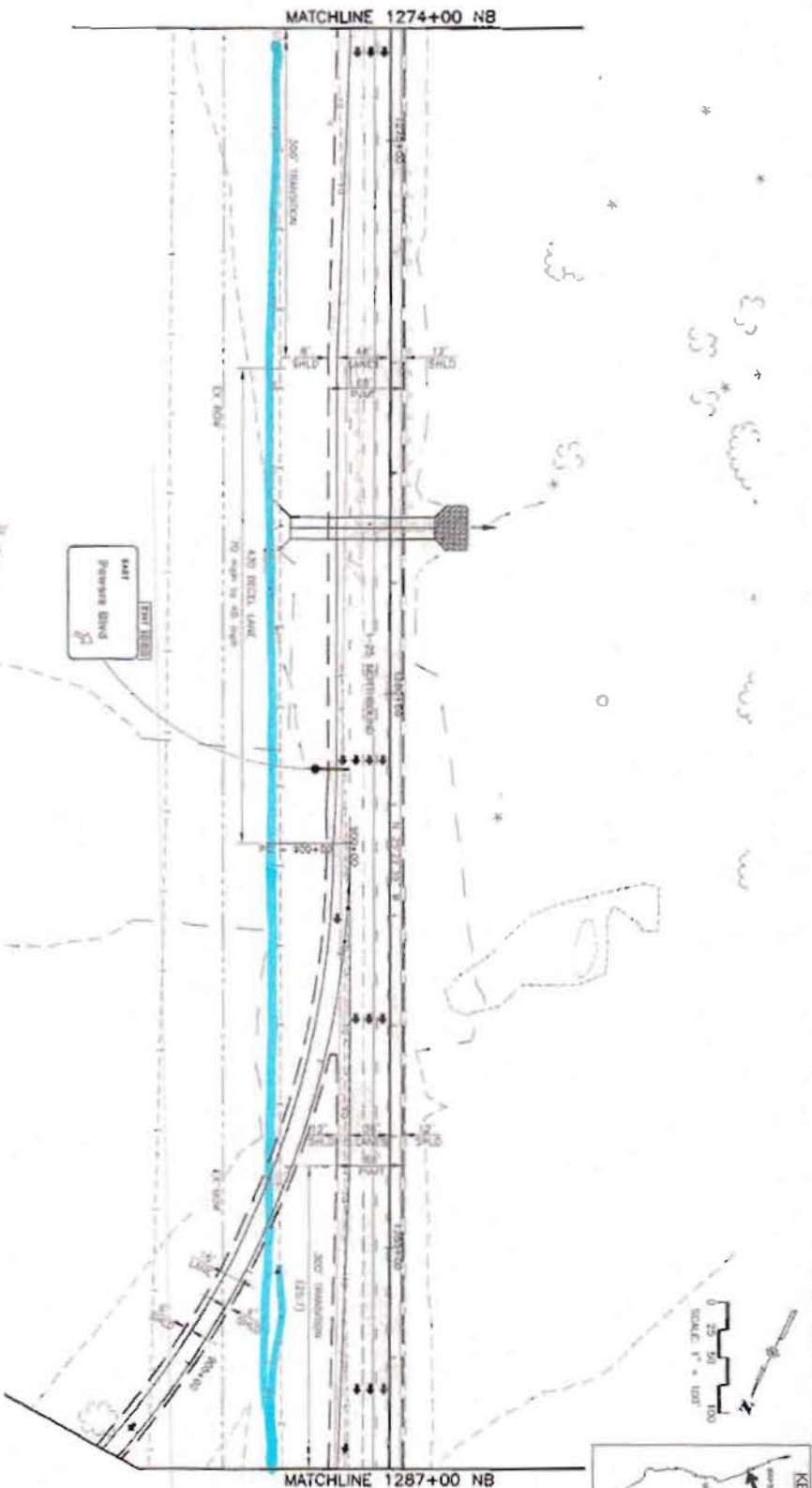

1-25 EA CONCEPTUAL DESIGN





<b>Computer File Information</b>		<b>Sheet Revisions</b>	
Creation Date: 11/7/01	Notes: wk		
Last Modification Date: 02/24/03	Notes: wk		
File Path: P:\181103\13\KCN\PROJECTS	Notes: wk		
Drawing File Name: 02/24/03-02.DWG	Notes: wk		
Model No.: 2100	Scale: As Shown	Units: English	CR:
<b>Colorado Department of Transportation</b>		<b>As Constructed</b>	
 1480 David Lane Littleton, Suite A Colorado Springs, Colorado 80906 Phone: (719) 524-2323 Fax: (719) 277-5284 Region 2 JLT		Project No./Code C 0252-516 12210	
Highway: 1-25 Roadway Plan 1287+00 NB to 1300+00 NB		Designer: wk Checker: wk Date: 02/24/03	

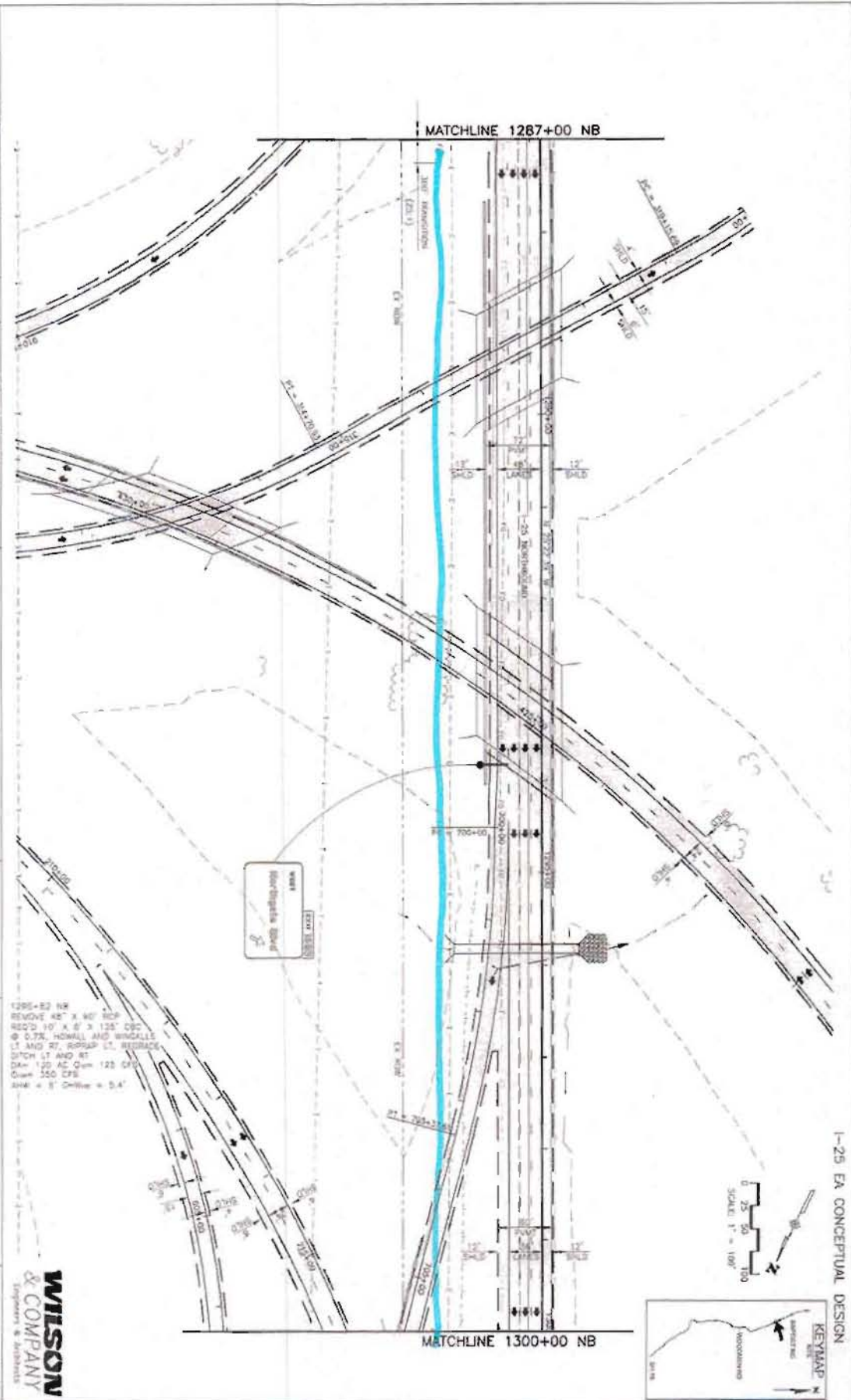

**Computer File Information**

Creation Date:	11/9/01	Author:	MMB
Last Modification Date:	02/29/03	Checker:	CEC
File Name:	P:\98102031\CD02\PLANETS		
Drawing File Name:	CD02PLAN-001.DWG	Units:	English
Plot Date:	2003	Scale:	As Shown

**Sheet Revisions**

**Colorado Department of Transportation**

1430 Quail Lake Loop - Suite A  
 Colorado Springs, Colorado 80906  
 Phone: (719) 534-2323 Fax: (719) 277-3386

Region 2

JTF

**As Constructed**

**1-25 Roadway Plan**

**1300+00 NB to 1313+00 NB**

Project No./Code: C 02242-316

Sheet Number: 12210

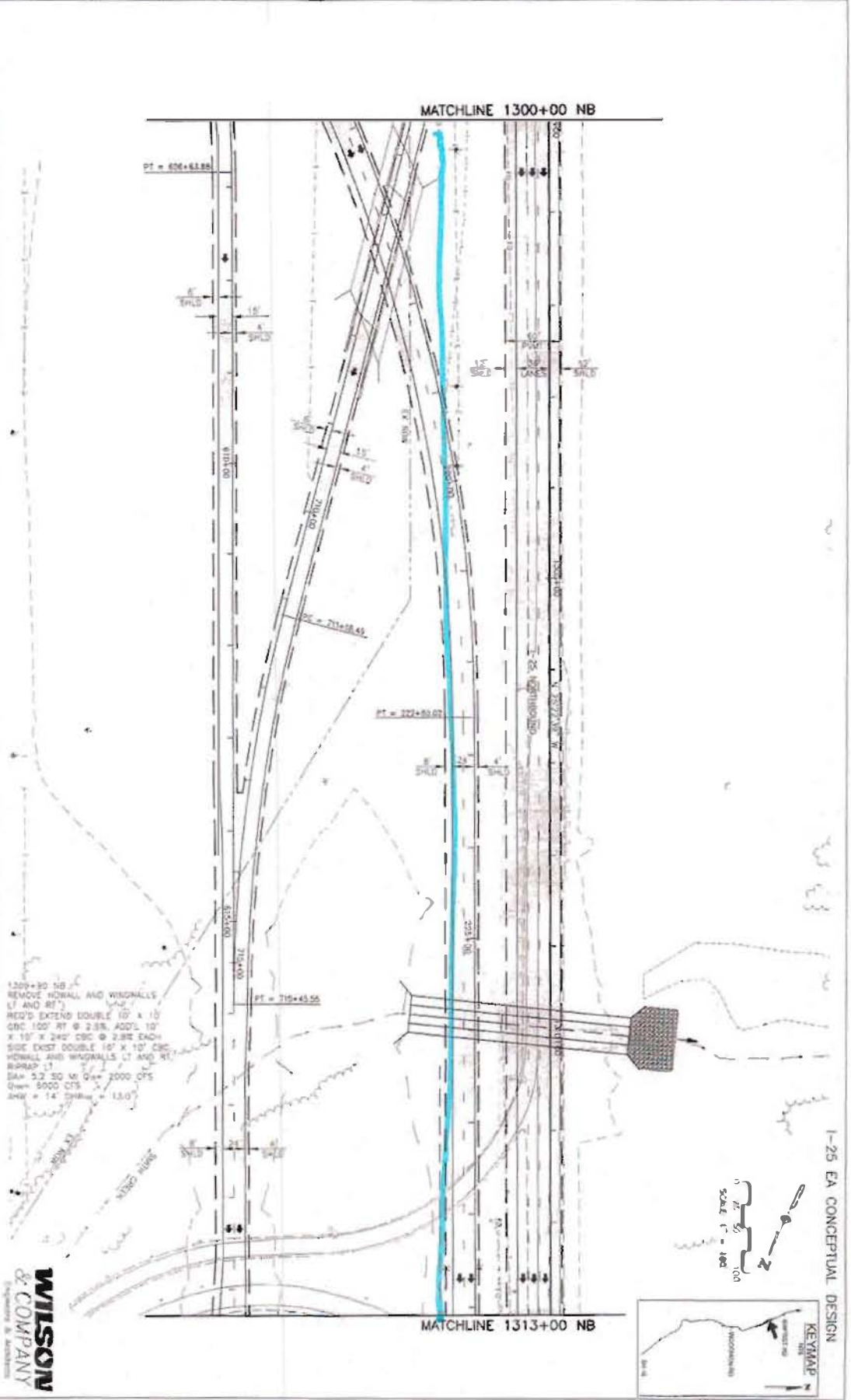



I-25 EA CONCEPTUAL DESIGN

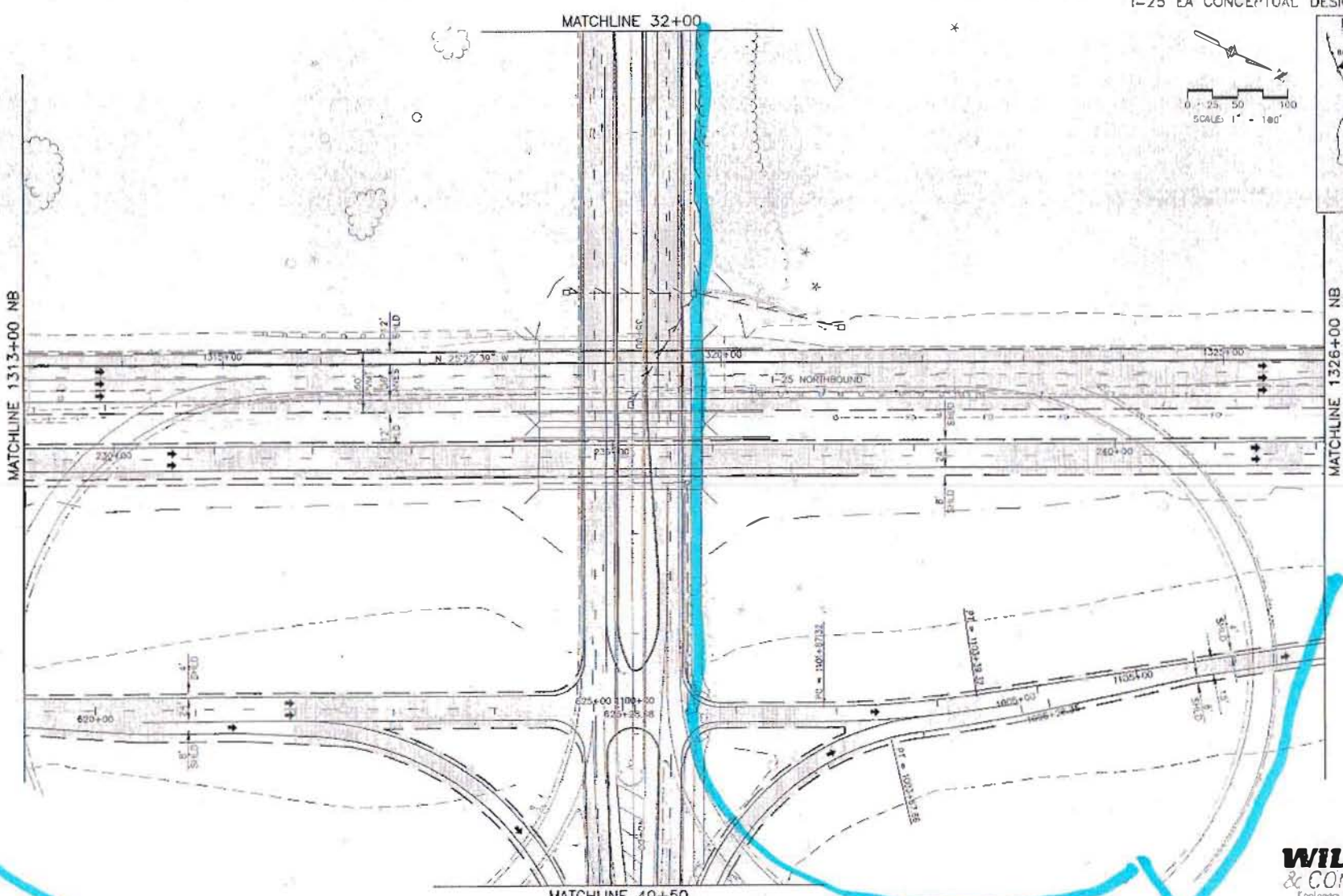
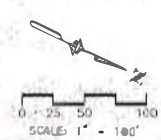

**WILSON & COMPANY**  
Engineers & Architects

<b>Computer File Information</b> Creation Date: 11/6/01 Last Modification Date: 02/28/03 Full Path: P:\88316001\ACAD\VSHEETS Drawing File Name: RDPL56H-905.DWG Acad Ver: 2000    Scale: As Shown    Units: English		<b>Sheet Revisions</b> <table border="1"> <tr><td> </td><td> </td></tr> <tr><td> </td><td> </td></tr> <tr><td> </td><td> </td></tr> </table>								<b>Colorado Department of Transportation</b>  1450 Quail Lake Loop - Suite A Colorado Springs, Colorado 80906 Phone: (719) 534-2323    Fax: (719) 537-3268 Region 2    JFF		<b>As Constructed</b> No Revisions: Project: Design: Detail: Sheet Subset: ROADWAY    Subsheet Sheet: 89 of 113		<b>I-25 Roadway Plan</b> 1313+00 NB to 1326+00 NB Project No./Code: C 0252-316 12210 Sheet Number	

**Computer File Information**

Order Date:	11/7/01	Initial:	WJC
Last Modification Date:	07/23/03	Initial:	WJC
File Path:	E:\VMS\001\1\ACD\03\04\015		
Drawing File Name:	03P601-3C.DWG	Sheet Type:	03-C
Year:	2000	Scale As Shown:	As Shown

**Sheet Revisions**

**Colorado Department of Transportation**

**Region 2**

1480 Good Loop Lane - Suite A  
 Denver, CO 80202  
 Phone: (303) 439-3333 Fax: (303) 239-5282  
 JFF

**As Constructed**

No. Revisions:	
Revised:	
Year:	

**I-25 Roadway Plan**

Design:	WJC
Checker:	WJC
Sheet Number:	
Sheet Size:	30" x 42" (1:1)

**Project No./Code**

	C 0252-316
	12210

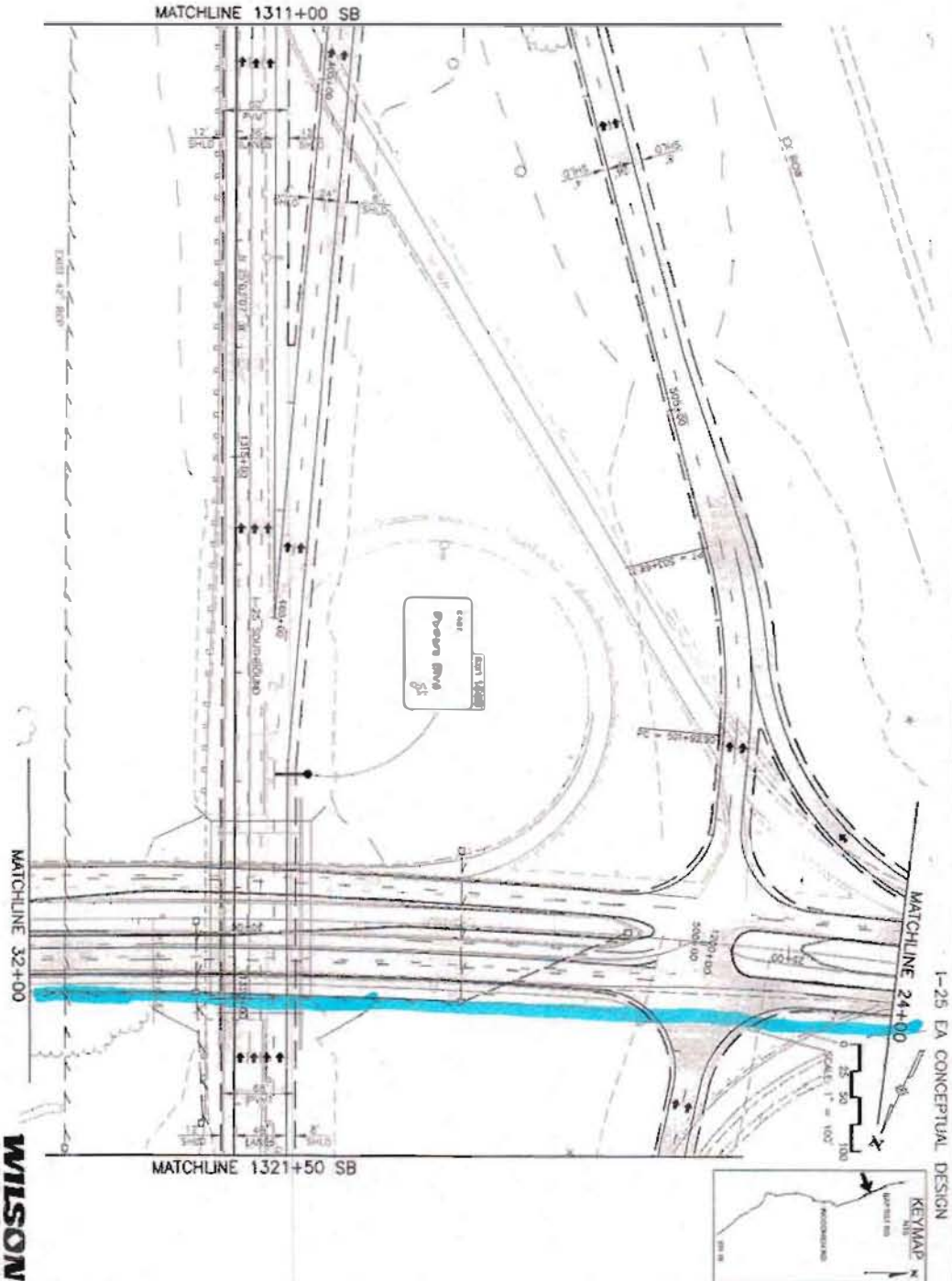

I-25 EA CONCEPTUAL DESIGN



**Computer File Information**

Project Name	1/24/01	Station	110
Lead Worksheet Date	02/28/01	Station	110
File Name	F:\30311001\1-25\01\04171	Station	110
Issuing File Name	001-100-011-001	Station	110
Sheet No.	2000	Scale	As Shown

**Sheet Revisions**

**Colorado Department of Transportation**

1480 Quail Lake Lane - Suite A  
 Colorado Springs, Colorado 80906  
 Phone: (719) 534-2322 Fax: (719) 277-3188

Region 2

**As Constructed**

No. Revisions	
Revised	
Year	

**1-25 Roadway Plan**

**1326+00 NB to 1339+00 NB**

Designer	W&C
Checker	W&C
Sheet Scale	00 NB of 113

**Project No./Code**

C 0252-316

12210

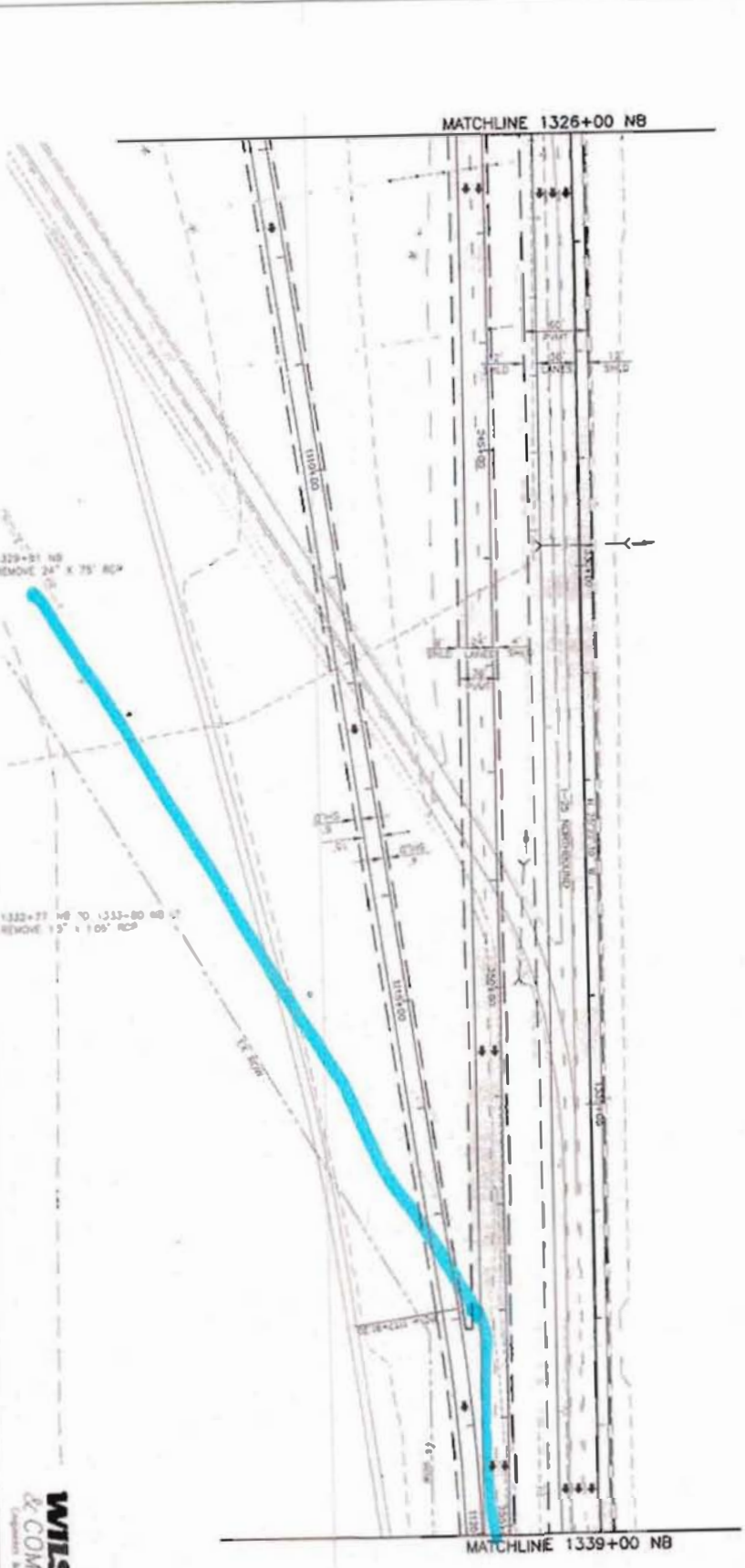

**KEYMAP**

**1-25 EA CONCEPTUAL DESIGN**

SCALE: 1" = 100'

**WILSON & COMPANY**  
 Engineers & Architects

<b>Computer File Information</b>		<b>Sheet Revisions</b>	
Creation Date	11/17/05	Rev	01
Last Modification Date	01/26/06	Rev	02
File Path	P:\1339+00 NB\1339+00 NB.dwg	Rev	03
Drawing File Name	1339+00 NB.dwg	Rev	04
Sheet No.	2005	Sheet No.	01

<b>Colorado Department of Transportation</b>		<b>As Constructed</b>	
1480 Quar Lane Loop - Suite A	1339+00 NB to 1352+00 NB	Design	1339+00 NB to 1352+00 NB
Colorado Springs, Colorado 80906	Project No./Code	Drawn	C 0252-316
Phone: (719) 534-3333 Fax: (719) 221-2995	122110	Sheet Number	113
JTF			

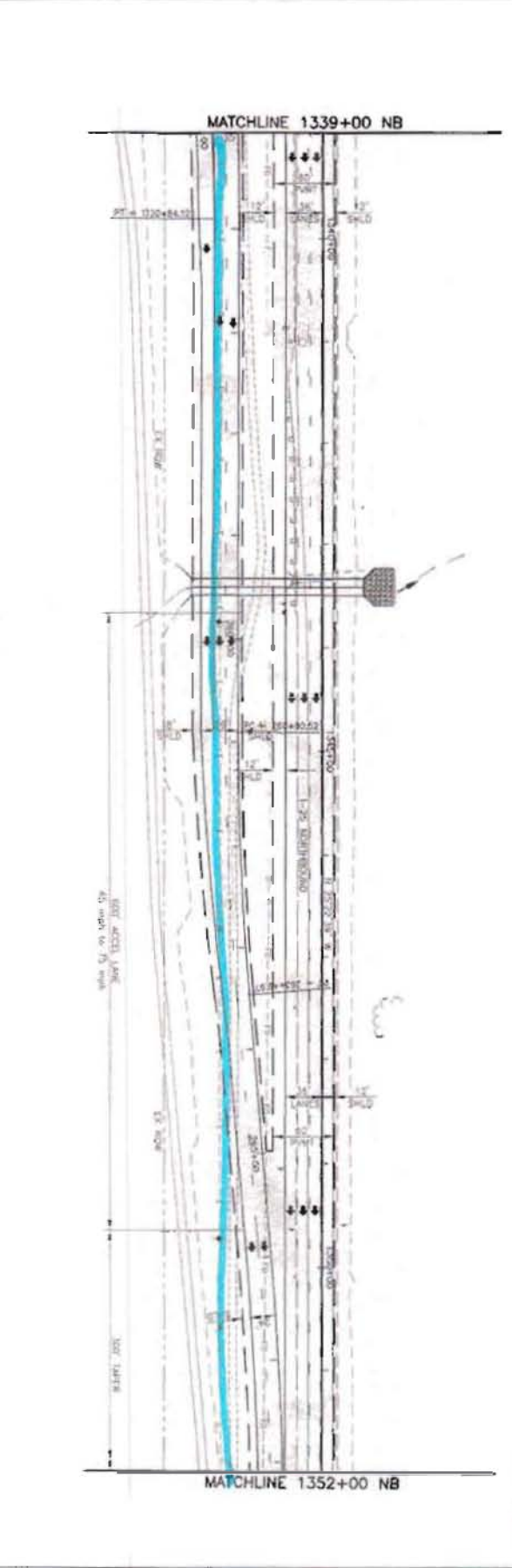

**1-25 EA CONCEPTUAL DESIGN**

**KEYMAP**

**SCALE: 1" = 100'**

**WILSON & COMPANY**  
 ENGINEERS & ARCHITECTS

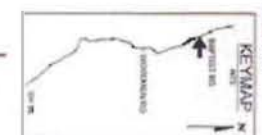
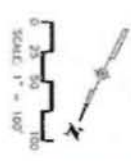
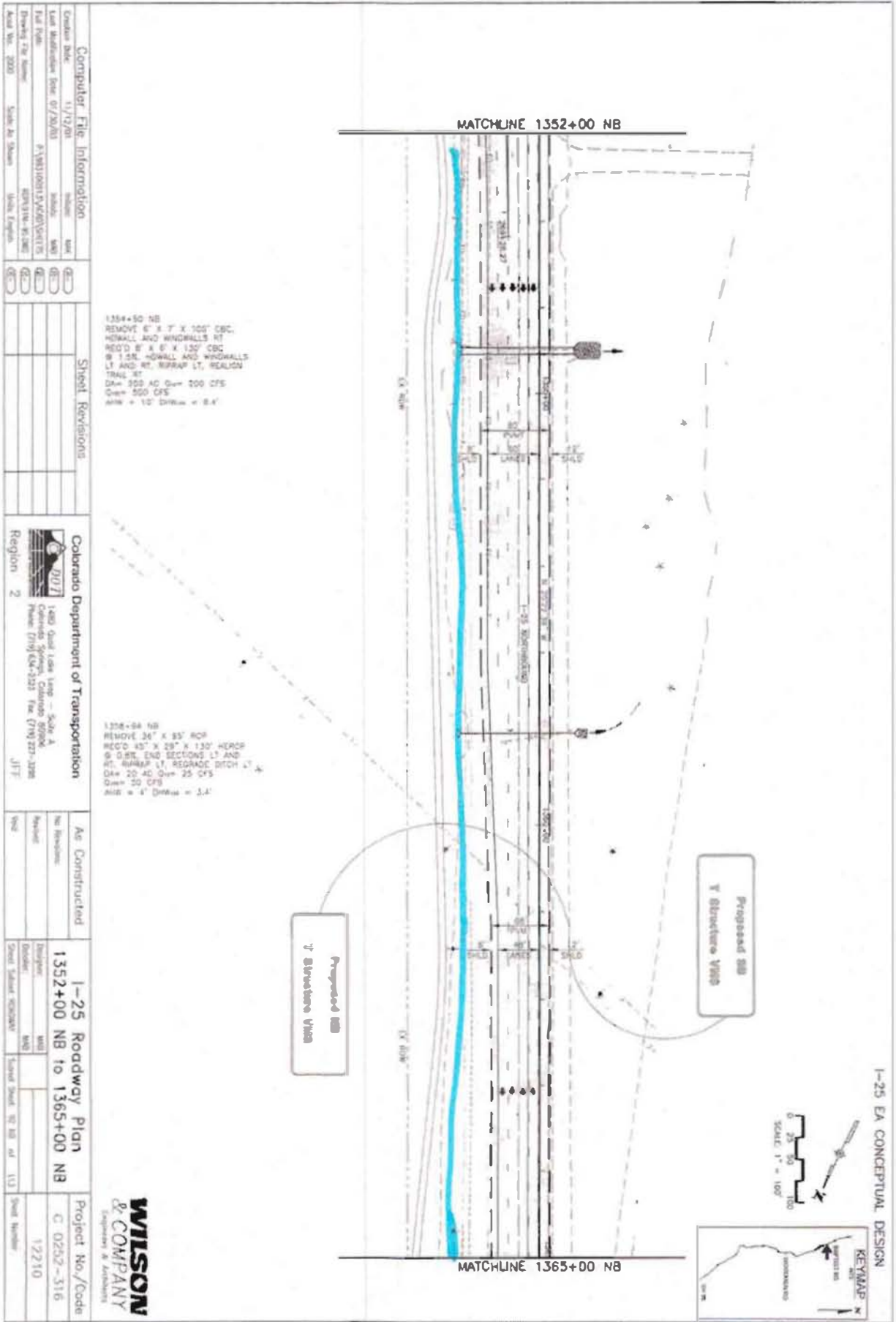

1-25 EA CONCEPTUAL DESIGN

**Computer File Information**

Customer Date:	11/17/01	Sheet:	100
Lead Architect:	07/25/03	Scale:	ASB
Lead Engineer:	P/AN/10/01/11/14/03/04/05/07/08	Drawn:	EC
Drawn:	07/25/03	Checked:	EC
Lead Designer:	07/25/03	Reviewed:	EC
Lead Checker:	07/25/03	Approved:	EC

**Sheet Revisions**

**Colorado Department of Transportation**

1480 Quail Loop Lane - Suite A  
 Colorado Springs, Colorado 80906  
 Phone: (719) 634-3325 Fax: (719) 271-3285

Region 2

**As Constructed**

No. Revisions:	
Revised:	

**1-25 Roadway Plan**

1352+00 NB to 1365+00 NB

Designer:	WAS
Checker:	WAS
Lead Designer:	
Lead Checker:	

Sheet 100 of 113

**Project No./Code**

C 0252-316

12210





CURVE DATA										
Curve No.	A <sub>1</sub>	A <sub>2</sub>	A <sub>3</sub>	L <sub>1</sub>	L <sub>2</sub>	L <sub>3</sub>	WOS	SSD	STA	
1	27	07°42'17"	070923'	24723'	24828'	24837'	0034'	0034'	NO	2910

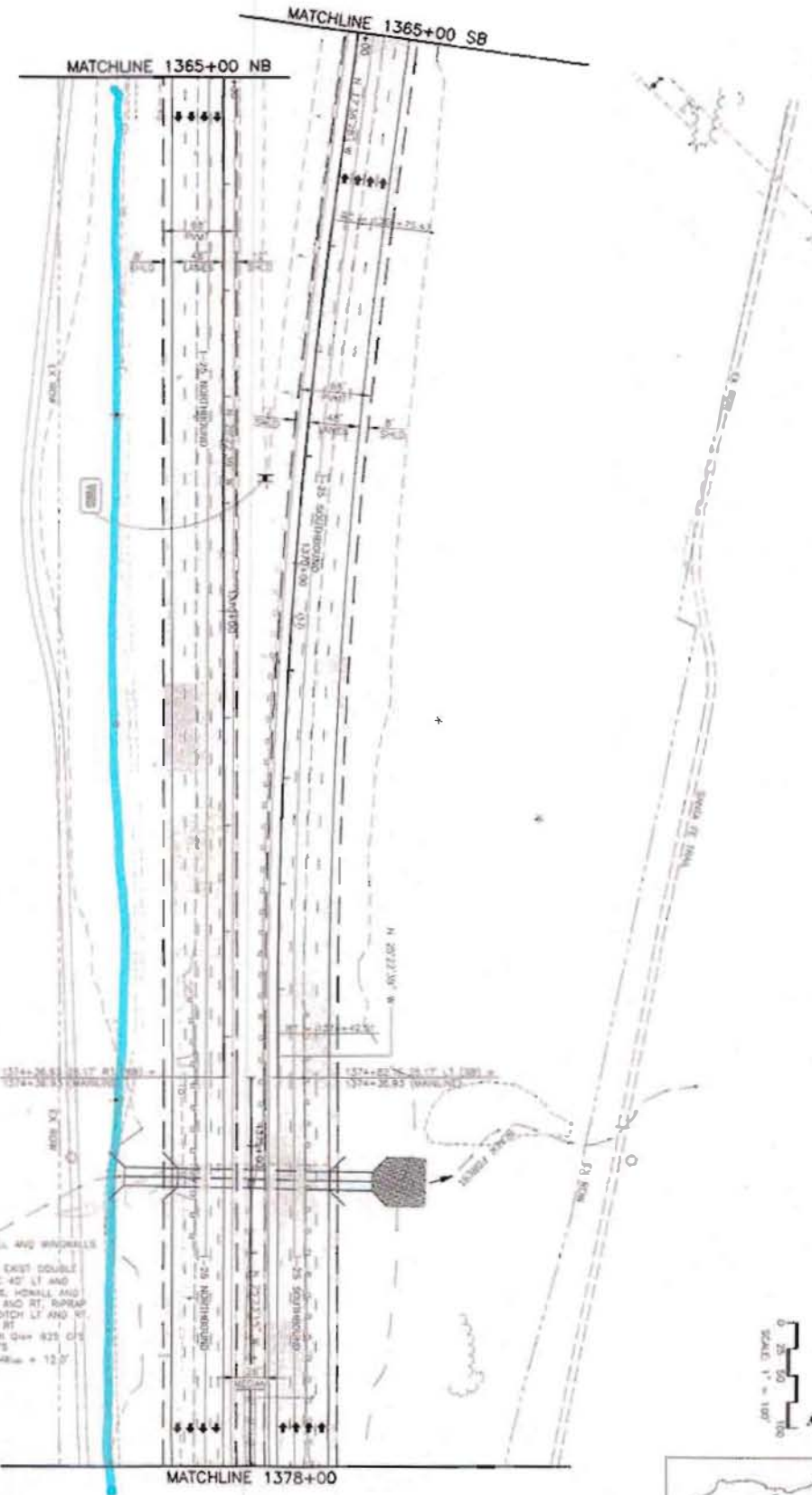

1375+34  
REMOVE NOWALL AND WINDWALLS  
LT AND RT  
25' @ EXTEND EXIST DOUBLE  
LINE AT @ 0.75% HORNL AND  
WINDWALLS LT AND RT, REPAIR  
REGRAD DITCH LT AND RT.  
REALIGN TRAIL, RT  
45' @ 2.00% @ Sta 625 TO  
STA 630  
45' @ 1.75% @ Sta 630  
AND + 12.0'

<b>Computer File Information</b>		<b>Sheet Revisions</b>		<b>Colorado Department of Transportation</b>		<b>As Constructed</b>		<b>I-25 Roadway Plan</b>		<b>Project No./Code</b>	
Customer Use:	11/7/2011	Scale:	3/8"	1400 Good Loop - Suite A Colorado Springs, Colorado 80905 Phone: (719) 633-2253 Fax: (719) 307-3586	No. Submits:		1365+00 to 1378+00 SHEET NUMBER	SHEET SCALE: 3/4" OF 1 1/4"	SHEET NUMBER: 12210	WILSON & COMPANY Engineers & Architects	C 0252-316
Last Modification Date:	07/26/2011	Author:	JMO		Revisions:						
File Path:	F:\311002\1\AD\DWG\T\Drawings\25_Rep_Plan_24_12/19/2013 04:25:25 PM	Checked:	WJM	Region:	2	Sheet Name:		Sheet No.:	12210		
Drawing File Name:	REP3110-25.PLC	Drawn:	JEF								
Drawn By:	JEF	Scale As Shown:									

I-25 EA CONCEPTUAL DESIGN

<b>Computer File Information</b>		<b>Sheet Revisions</b>		<b>Colorado Department of Transportation</b>		<b>As Constructed</b>		<b>1-25 Roadway Plan</b>		<b>Project No./Code</b>	
Custom Title:	11/12/01			<b>DOT</b>		No.:		<b>1378+00 to 1391+00</b>		<b>C 0252-315</b>	
Last Modification Date:	01/29/03			1480 Quail Lake Loop - S. Side A		Project:		Design:		<b>12210</b>	
Draw File Path:	F:\MOTORWAY\CD\1378-00			Colorado Department of Transportation		Sheet:		Checker:		12210	
Drawing File Name:	1378-00-12210.dwg			Project File: 1378-00-223		Title:		Designer:		12210	
AutoCAD Ver.:	2000			Phone: (303) 867-3222		Scale:		Checker:		12210	
Scale:	As Shown			Fax: (303) 771-3208		Notes:		Sheet Size:		11.3	
Units:	English			JFF		As Constructed		Sheet Size:		11.3	

1579+50  
 REMOVED C & P & 150' CBG  
 42" x 25" 30' CBG  
 IMPROVED 3.5:1  
 RELOCATED 53' x 34' x 250' WEACP  
 INLET TYPE C MEDIAN, REFRAP  
 RECORD DITCH RT, REALIGN  
 1579+50 AC 0.4 = 22 GPS  
 55.71  
 73.73  
 8.35

1378+23  
 60" x 4' x 4' x 350' CBG  
 REFRAP RT WINDWALLS LT AND RT  
 RECORD 76' x 48' x 280' WEACP  
 15' HIGH C&P INLET TYPE C  
 (TRANS) C  
 INLET TYPE C MEDIAN  
 RECORD DITCH RT  
 55.71  
 73.73  
 8.35

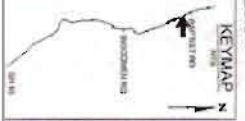

1-25 EA CONCEPTUAL DESIGN

**WILSON**  
**& COMPANY**  
 ENGINEERS & ARCHITECTS

Computer File Information	
Creation Date	11/17/01
Last Modification Date	01/20/03
File Path	F:\98010901\1\CONTR\SETLS
Drawing File Name	1391-1404.DWG
Plot No.	2020
Scale As Shown	1/8" = 1'-0"
Units	FEET

Sheet Revisions	

**Colorado Department of Transportation**



1400 East Lake Loop - Suite A  
 Colorado Springs, Colorado 80906  
 Phone: (719) 634-2323 Fax: (719) 227-2398

Region 2

As Constructed	
By	
Checked	

1-25 Roadway Plan	
1391+00 to 1404+00	

Project No./Code	
C 0252-316	
12210	

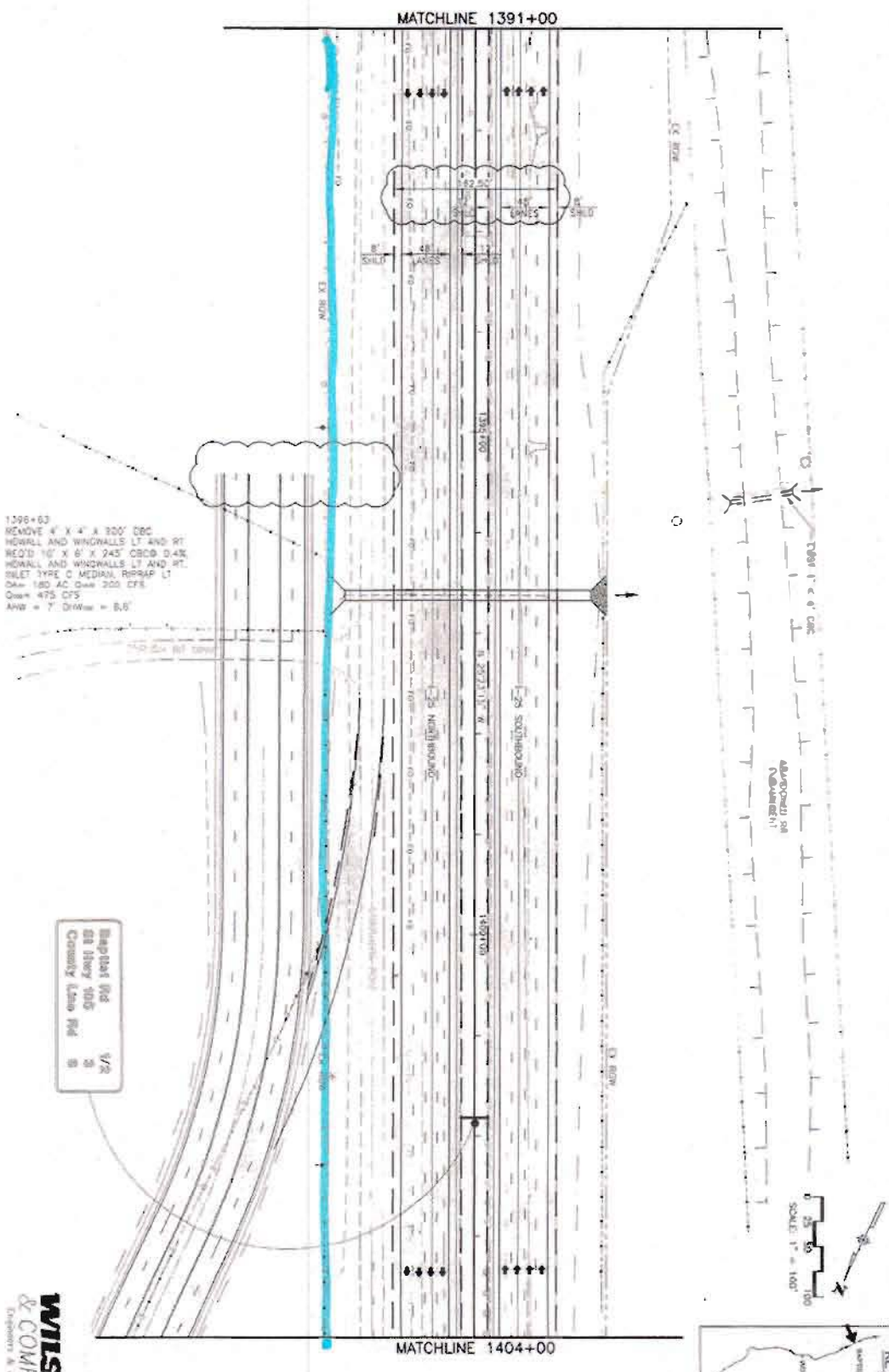

1396+63  
 REMOVE 4' X 4' X 200' CONC  
 NOWALL AND WINGWALLS LT AND RT  
 REQ'D 10' X 6' X 245' CONC D&K  
 NOWALL AND WINGWALLS LT AND RT.  
 SILET TYPE C MEDIAN RIPRAP LT  
 Q&W = 180 AC Drain 200 CFS  
 Q&W = 475 CFS  
 AWW = 7' Drain = 5.5'

Revised 01/20/03  
 by JWB  
 County Lane Rd

**1-25 EA CONCEPTUAL DESIGN**



SCALE: 1" = 100'

**WILSON & COMPANY**  
 Engineers & Architects





I-25 EA CONCEPTUAL DESIGN

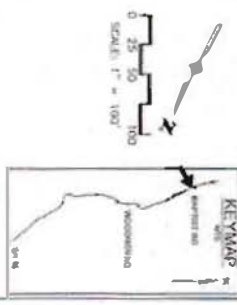

Computer File Information		Sheet Revisions		Colorado Department of Transportation		As Constructed		I-25 Roadway Plan		Project No./Code	
Code: 306	11/6/01	11/6/01	11/6/01	11/6/01	11/6/01	11/6/01	11/6/01	11/6/01	11/6/01	11/6/01	11/6/01
Last Modification Date: 01/23/03											
File Path: P:\V\102011\1\KADU\1417-1430											
Display File Name: 01/23/03 10:06:00											
Asset No.: 2000	Sheet No.: 0001	Sheet Title: 0001	Sheet Size: 11.5	Sheet No.: 0001	Sheet Title: 0001	Sheet Size: 11.5	Sheet No.: 0001	Sheet Title: 0001	Sheet Size: 11.5	Sheet No.: 0001	Sheet Title: 0001

**WILSON & COMPANY**  
Engineers & Architects

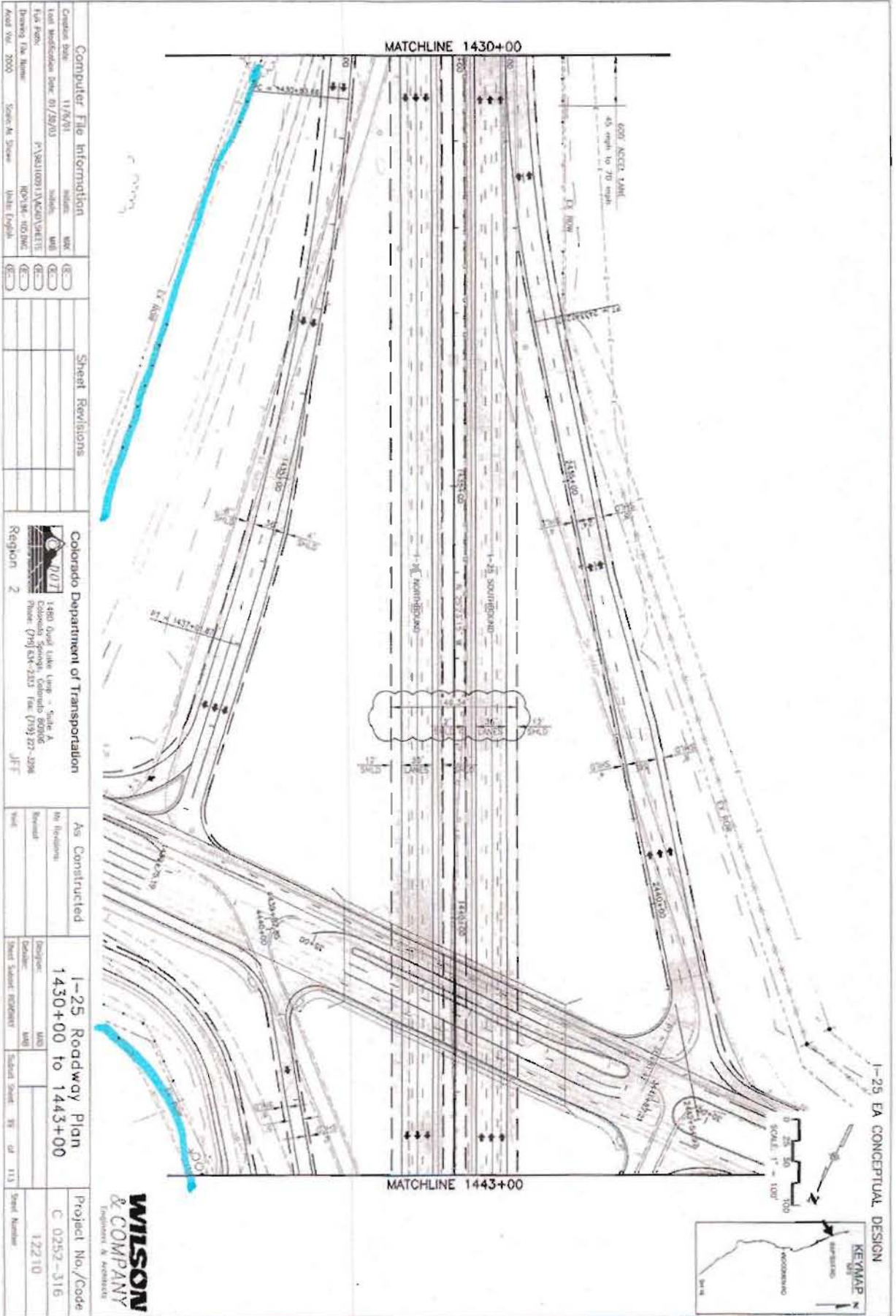

Computer File Information		Sheet Revisions		Colorado Department of Transportation		As Constructed		I-25 Roadway Plan		Project No./Code	
Created Date	11/8/01	WK	(C)	Region	2	No. Revisions	0	1430+00 to 1443+00	C 0252-316	Sheet No./Code	12210
Last Modified Date	01/29/03	WK	(C)	1800 David Lake Loop, Suite A Colorado Springs, Colorado 80906 Phone (719) 524-2337 Fax (719) 527-3298 J.F.F.		Revised		Designer	WAO	Checker	WAO
Drawn File Name	P:\17811\001\17811\17811\17811.dwg	WK	(C)			Sheet	12210	Sheet	12210	Sheet	12210
Drawn File Name	17811-17811.dwg	WK	(C)			Sheet	12210	Sheet	12210	Sheet	12210
Drawn File Name	17811-17811.dwg	WK	(C)			Sheet	12210	Sheet	12210	Sheet	12210

**WILSON & COMPANY**  
Engineers & Architects

I-25 EA CONCEPTUAL DESIGN



**Computer File Information**

Current Date:	11/6/01	Author:	WJC
Last Worksheet Date:	01/29/01	Editor:	WJC
File Path:	P:\MS\0001\W\CD\01\WJ\101	Printer:	EPSON
Drawing File Name:	REV06-100.DWG	Plotter:	HP-100/2MS
Acad Ver.:	2000	Scale to Sheet:	Units English

**Sheet Revisions**

**Colorado Department of Transportation**

Region 2

1800 Cook Lake Loop - Suite A  
 Denver, CO 80202  
 Phone: (719) 524-2023 Fax: (719) 277-5704

JTF

**As Constructed**

By:	
Checked:	
Date:	

**I-25 Roadway Plan**

1443+00 to 1456+00

Design:	WJC
Drawn:	WJC
Sheet Number:	102 of 111

**Project No./Code**

C 0252-316

12210

**WILSON & COMPANY**  
 Engineers & Architects

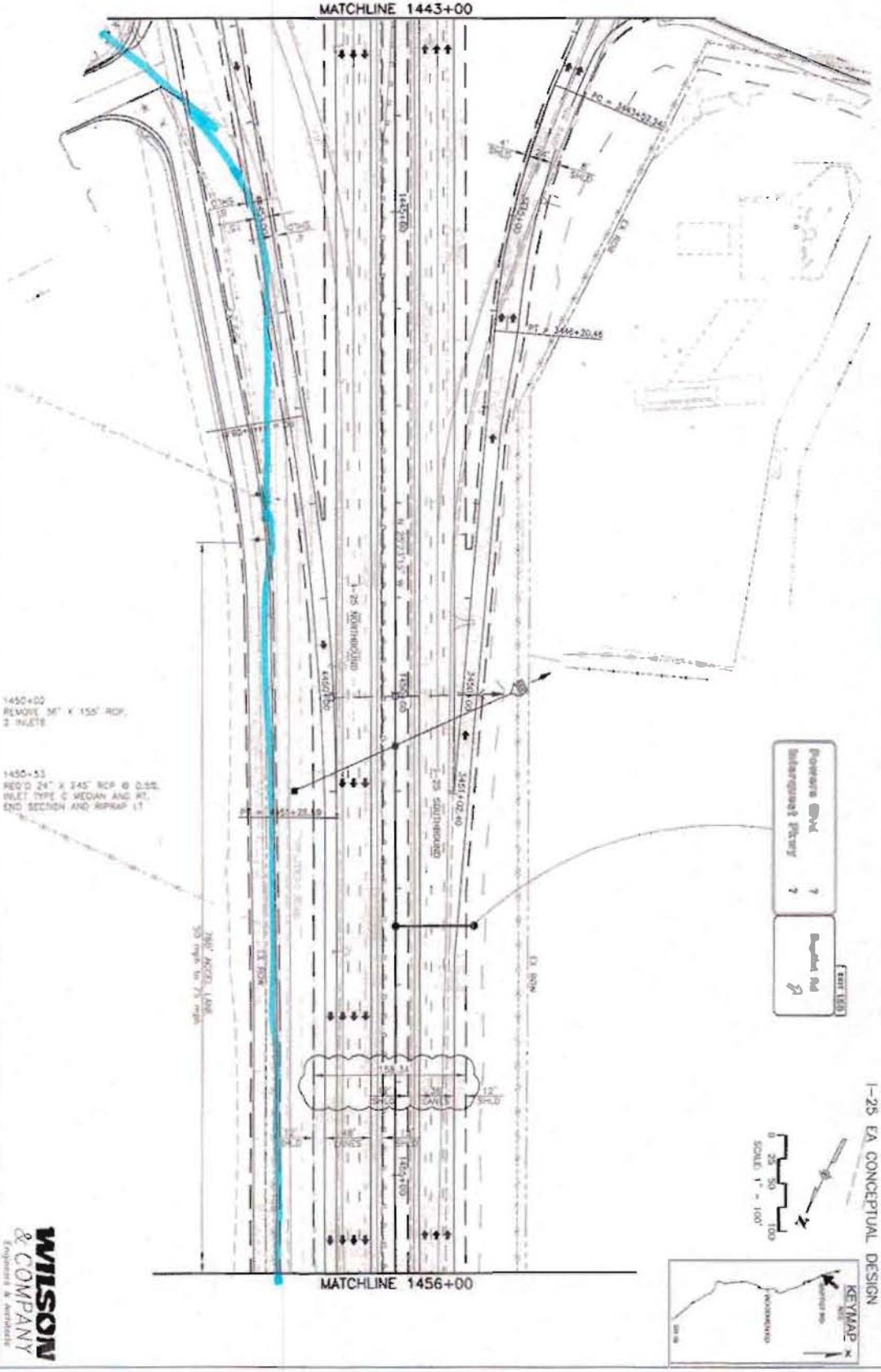

Project No. 7  
 Subproject No. 2

Sheet 102 of 111



I-25 EA CONCEPTUAL DESIGN

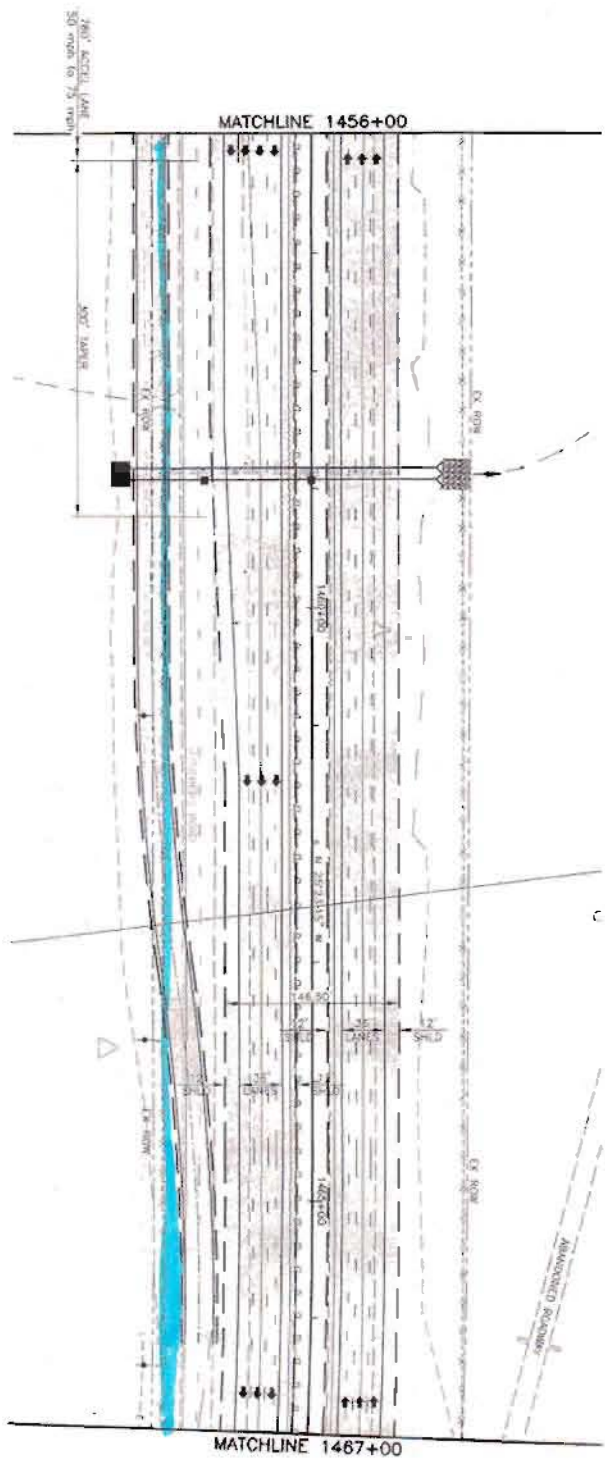

1-25 EA CONCEPTUAL DESIGN

1456+28  
 REMOVE 30" x 185' RCP,  
 2 INLETS  
 REQ'D DOUBLE 75" x 48" x 285'  
 MERCP @ 0.8% INLET TYPE C  
 MEDIAN AND RT. INLET SPECIAL  
 (16 TYPE C) RT. END SECTIONS  
 AND APPROX. 17' REDUCED WIDTH L  
 QM = 90 AC QM = 100 CFS  
 Qmax = 200 CFS  
 ANW = 5' D/W = 4.4'

Computer File Information			
Creation Date:	11/6/01	Index:	MAX
Last Modification Date:	01/20/02	Layers:	MAX
Plot Path:	F:\VAD100113\ACD\01\SHEETS	Plots:	0
Drawing File Name:	101136_181.DWG	Under Erase:	0
Acad Ver:	2000	Under Erase:	0

Sheet Revisions			

**Colorado Department of Transportation**



1456+00 to 1467+00 Roadway Plan - Sheet A  
 1456+00 TO 1467+00 ROADWAY PLAN  
 Project: (111) 145-2023 Date: (11/22)-2008  
 JLF

As Constructed	
As Constructed	
Revised	
Not	

1-25 Roadway Plan	
1456+00 to 1467+00	
Sheet: 145	
Sheet Count: 101	of 113

Project No./Code	
C 0252-315	
12210	
Sheet Number:	

**WILSON & COMPANY**  
 Engineers & Architects

CURVE DATA							
CURVE NO.	A <sub>1</sub>	E <sub>2</sub>	R <sub>1</sub>	E <sub>1</sub>	V <sub>a</sub>	Δ	MOE. SUB.
211	1439.13	6079.27	6200.00	15.78.45	741.36'	0.034	MO 2010

# I-25 EA CONCEPTUAL DESIGN

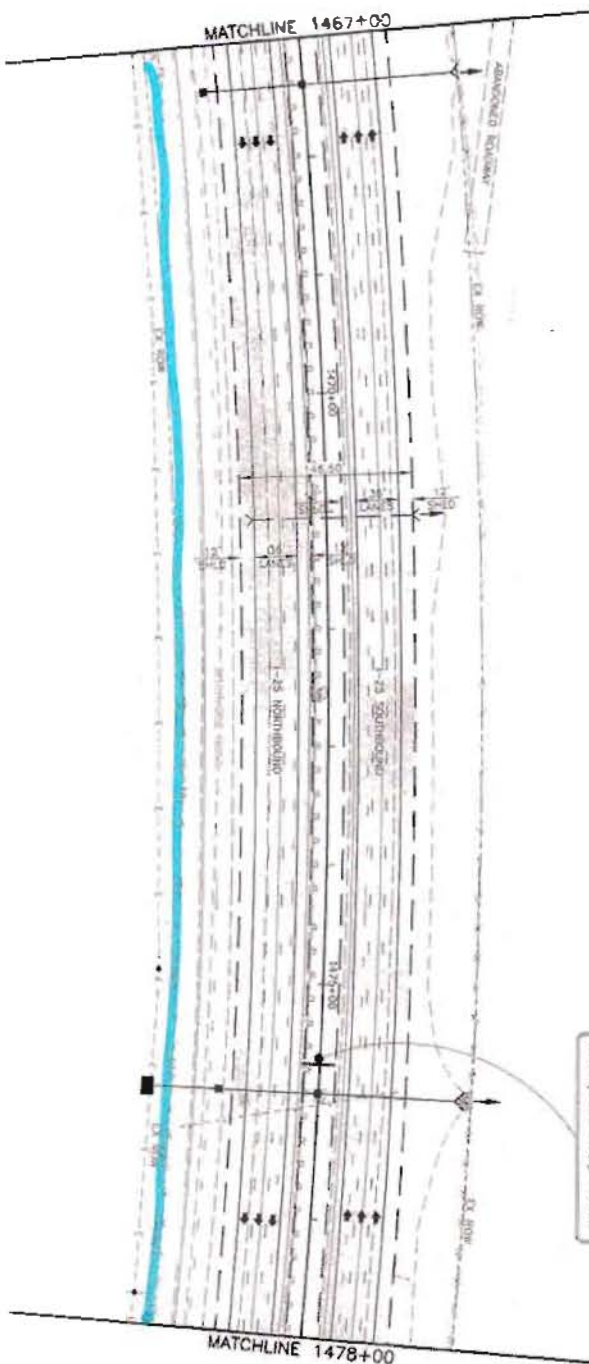
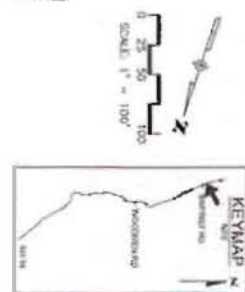

Right of Way: 5/2  
 Project Blvd: 7  
 Intersecting Hwy: 5/2

1467+45  
 REMOVE 24" X 210 RCP @ 2'-0" DIA. INLET TYPE C MEDIAN AND RT. END SECTION AND REBAR LT

1471+55  
 REMOVE 30" X 120' RCP

1475+53  
 REMOVE 24" X 150' RCP, 2 INLETS, RECD 55" X 45" H/C/BP, @ 0.02% INLET TYPE C MEDIAN AND RT. END SECTION AND REBAR LT, 54' 40' AC @ 30' CFS, DIA# 125 CFS, ANR = 6' D/WAY = 4.7'

Computer File Information		
Circle Date	11/6/01	Sheet
Last Modification Date	11/28/03	NOB
File Path	P:\MKT\0311\VCAN\SHETS	
Drawing File Name	1031-NO-101.DWG	BBP
Acad Ver	2000	Sheet As Shown

**Colorado Department of Transportation**  
  
 1480 Gault Lake Lane - Suite A  
 Denver, Colorado 80202  
 Phone: (303) 634-2235 Fax: (303) 725-2094  
 J.F.F.

As Constructed	Project Title
No. Revisions: _____ Revisions: _____ Date: _____	<b>I-25 Roadway Plan</b> <b>1467+00 to 1478+00</b>

Project No./Code	C 0252-316
Sheet Number	12210





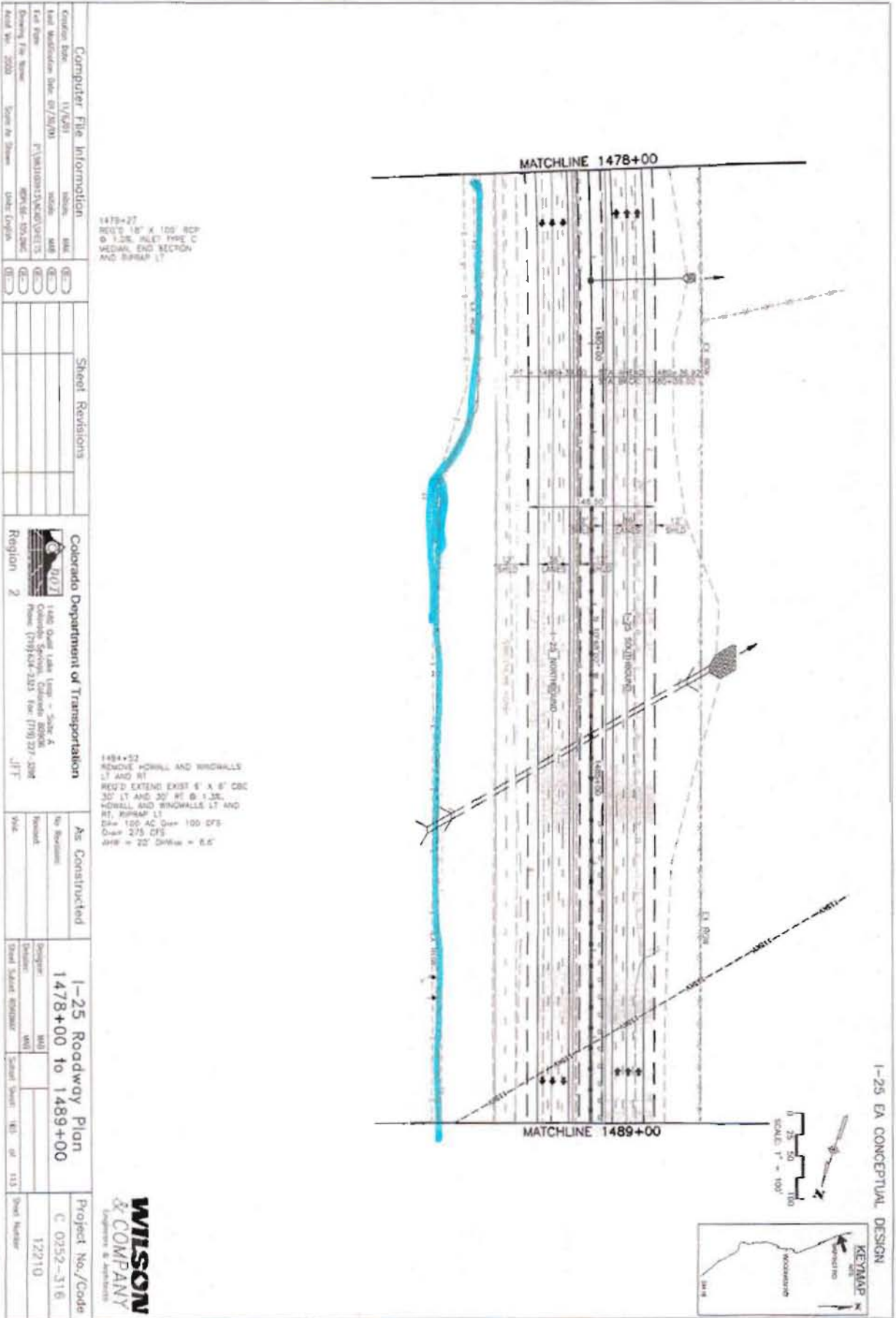

I-25 EA CONCEPTUAL DESIGN

**WILSON & COMPANY**  
 ENGINEERS & ARCHITECTS

Computer File Information		Sheet Revisions		Colorado Department of Transportation		As Constructed		I-25 Roadway Plan		Project No./Code	
Creation Date:	11/4/07			Region:	2	By:	WJ	Station:	1478+00 to 1489+00	Project No./Code:	C 0352-316
Last Modification Date:	07/24/08			Region:	2	Checked:	WJ	Sheet:	12210		
File Path:	F:\MIDWEST\13\KCD\07\0713			Region:	2	Drawn:	WJ	Sheet:	12210		
Drawing File Name:	08158-102.dwg			Region:	2	Design:	WJ	Sheet:	12210		
Acad Ver:	2008	Open in:	AutoCAD	Region:	2	Design:	WJ	Sheet:	12210		

1478+27  
 REQ'D 18" X 100' RCP  
 @ 1.25' INLET TYPE C  
 MEDIAN END SECTION  
 AND SURFACE LT

1484+52  
 REMOVE WALL AND WINDOWS  
 LT AND RT  
 REQ'D EXTEND EXIST 6' X 8' CURB  
 30' LT AND 30' RT @ 1.25'  
 WALL AND WINDOWS LT AND  
 RT, RIPRAP LT  
 12" DIA. 100 AC DIA= 100 CFS  
 DIA= 25 CFS  
 SHE = 20' DIA= 8.5'

**Colorado Department of Transportation**  
 1440 Duff Lake Loop - Suite A  
 Colorado Springs, Colorado 80906  
 Phone: (719) 542-3333 Fax: (719) 527-5094  
 JTF

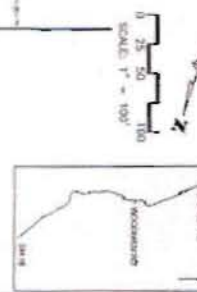

Computer File Information		Sheet Revisions	
Drawn Date	11/8/03	Author	MH
Last Modification Date	07/29/03	Check	MB
File Name	P:\VAL02031\VAL02031.DWG	Design	MB
Drawing Title	SR148-1502MC	Approved	MB
Auto Year	2003	Scale to Sheet	Scale Enlarge

Colorado Department of Transportation  
 Region 2  
 1489+00 Dual Lane Loop - Stage A  
 Project No. C 0252-31B  
 Issue 07/29/03 File 11/10/03 JFT

As Constructed	1-25 Roadway Plan	Project No./Code
No. Revisions Revised	1489+00 to 1502+00	C 0252-31B
Drawn Checked	Design Approved	12210
Sheet Number	Sheet Count	Sheet Number

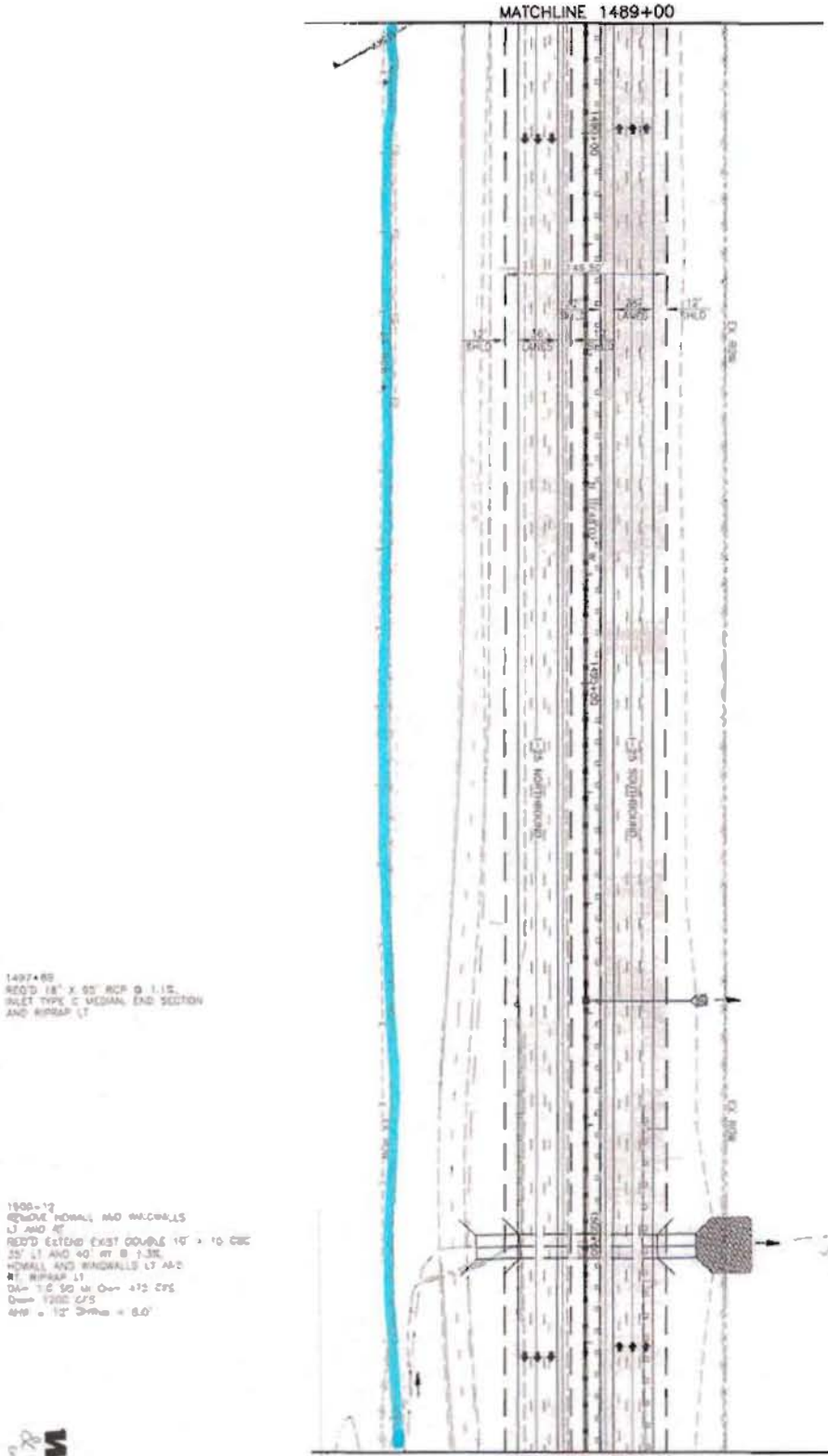

**WILSON & COMPANY**  
 ENGINEERS & ARCHITECTS

I-25 EA CONCEPTUAL DESIGN

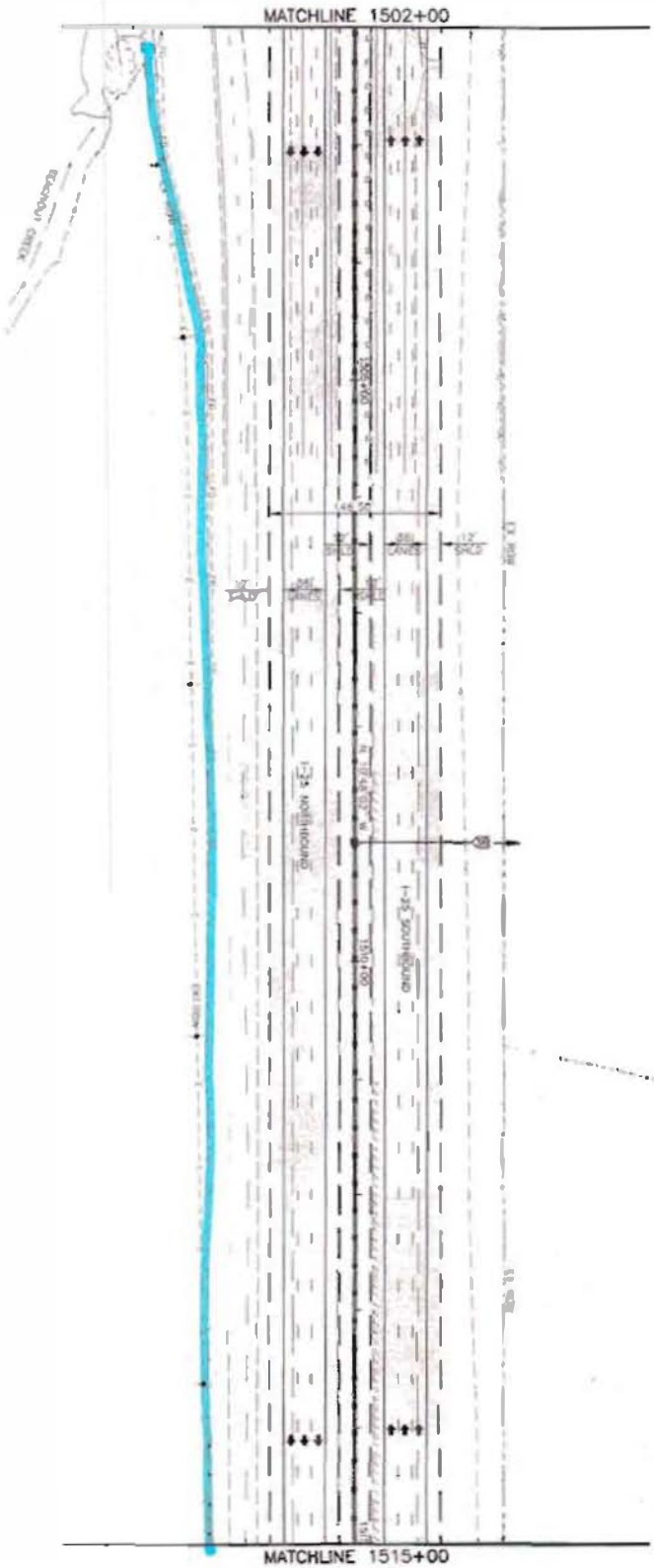
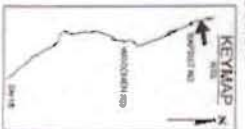

1502+00  
 40'0" 15' X 100' RCP  
 @ 1.25' INLET TYPE C MEDIAN  
 AND SECTION AND AIRMAP LT

**WILSON & COMPANY**  
 Engineers & Architects

Computer File Information		Sheet Revisions		Colorado Department of Transportation		As Constructed		Project No./Code	
Created Date	11/19/01	Revised	MM	 <b>Colorado Department of Transportation</b> 1480 Dual Lake Loop - Suite A Colorado Springs, Colorado 80901 Phone: (719) 534-3333 Fax: (719) 527-3238 JFT	to Revisions	<b>I-25 Roadway Plan</b> 1502+00 to 1515+00	Project No./Code	C 0252-316	
Last Modification Date	01/28/03	Revised	MM		Sheet		103 of 113	Sheet Number	12210
File Path	F:\PROJECTS\I-25\CDOT\CDOT	Revised	MM		Sheet				
Project File Name	CDOT-1515.DWG	Revised	MM		Sheet				
Drawn By	Steve M. Shaver	Revised	MM		Sheet				
Drawn Date	01/28/03	Revised	MM		Sheet				



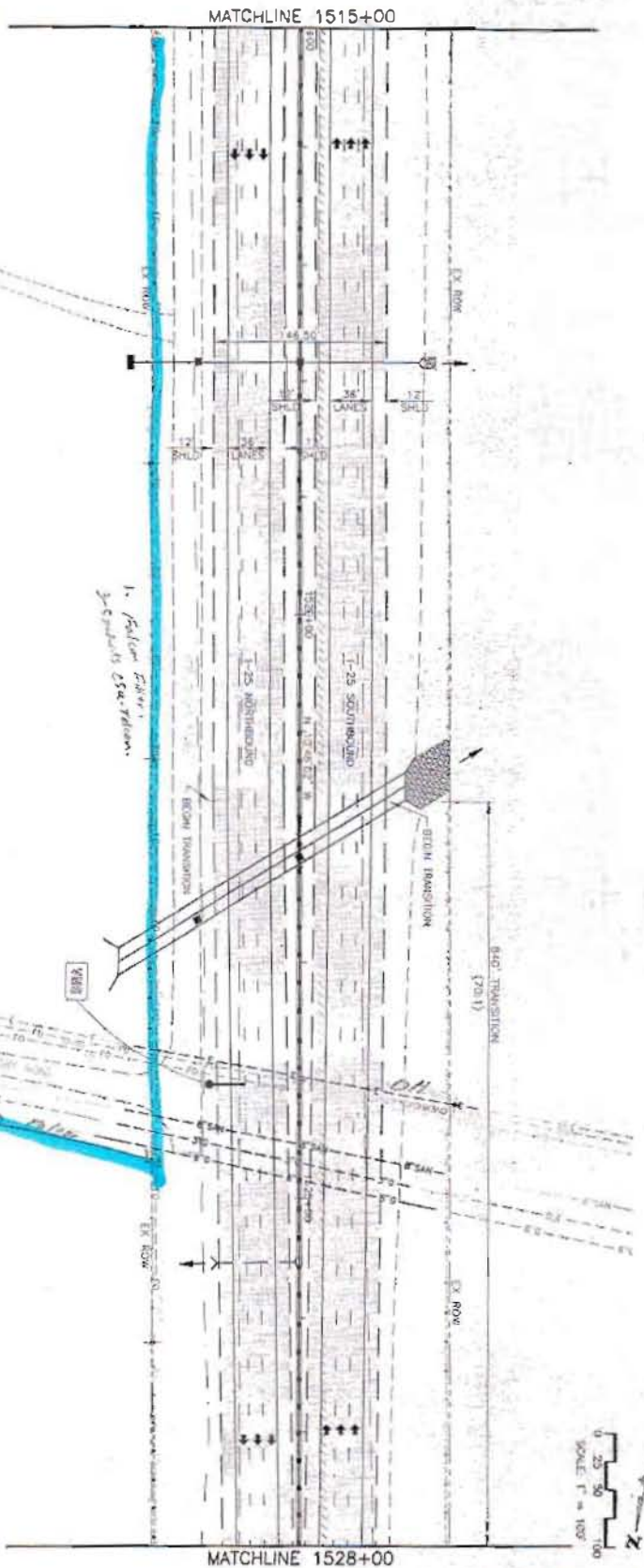
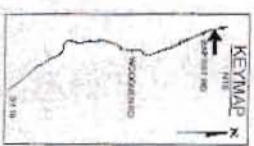

1517+54  
 REMOVE 2' X 2' X 60" CRC,  
 24" X 125" RCP, 2 INLETS  
 REQ'D 30" X 245" RCP @ 0.85,  
 INLET TYPE C MEDIAN AND RT,  
 INLET TYPE D HT, END SECTION  
 AND RIPRAP LT  
 DA= 10 AC Q<sub>max</sub> = 10 CFS  
 Q<sub>ave</sub> = 25 CFS  
 AW = 4' DH<sub>W</sub> = 2.8'

1522+03  
 REMOVE 4' X 4' X 225" CRC,  
 HOWALL AND WINGWALLS LT AND RT  
 REQ'D DOUBLE 10' X 6' X 285" CRC  
 @ 1.15, HOWALL AND WINGWALLS LT  
 AND RT, INLET TYPE C MEDIAN AND  
 RT, RIPRAP LT, REGRADE DITCH LT  
 DA= 340 AC Q<sub>max</sub> = 400 CFS  
 Q<sub>ave</sub> = 975 CFS  
 AW = 8' DH<sub>W</sub> = 7.2'

1525+53  
 REMOVE 24" X 70" RCP,  
 INLET

*1. Station Error  
 2. Station Correction*

**Computer File Information**

Creation Date:	11/13/20	Label:	WK
Last Modification Date:	01/30/21	Index:	MSJ
File Path:	F:\B8140801\WAD\PROJECTS		
Drawing File Name:	EPN106-113.DWG	QC:	QC
Model View:	2000	Scale/As Shown:	1/8" = 1'-0"

**Sheet Revisions**

**Colorado Department of Transportation**

1480 Quail Lake Lane - Suite A  
 Colorado Springs, Colorado 80906  
 Phone (719) 631-2323 FAX (719) 291-3288

Region 2

**As Constructed**

No. Revisions:	
Revised:	
Void:	

I-25 Roadway Plan  
 1515+00 to 1528+00

**Project No./Code**

C 0252-316
Sheet Number
12210

